

ELS-950 Series Rugged Electro-Optic Level Sensor

The ELS-950 Series represents Gems' smallest electro-optic level sensor developed to monitor a broad range of media including OHV type fluids.

Our design features a TPE over-molded electronics insert, TPE insulated wires, and fluorosilicone o-ring seals that create a watertight, environmentally resistant assembly, ideally suited for use in harsh environments.

The ELS-950 is excellent for industrial OEMs requiring a solid-state sensor for small space and high temperature environments.

Typical Applications

- Coolant reservoir monitoring and warning
- Medical diagnostic, sterilizer, washers and dialysis equipment
- Low lubricant warning on machine tools, generator sets, on- or off-highway vehicles
- Low level warning in hydraulic reservoirs
- Plastic over flow bottles, plastic radiators
- Leak detection for drip pans

Specifications

Materials	
Housing	Polysulfone (Contact Gems for alternative material types)
O-Ring	
1/2"- 20UNF Mounting	Fluorocarbon
M12x1-8 Mounting	Fluorocarbon
Electronics	Over-molded TPE
Operating Pressure	0 to 250 PSI (0 to 17 bar) maximum
Operating Temperature	-40°F to +230°F (-40°C to 110°C)
Current Consumptions (No Load)	
5 VDC	4 mA
12 VDC	10mA
Output	Sink 40 mA max., up to 30 VDC
Repeatability	±1 mm

Dimensions

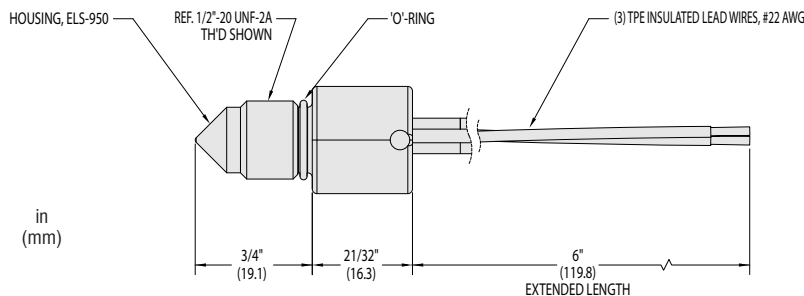

How To Order

Specify Part Number based on Input and Output Condition required.

Input Power	Actuation Condition	Mounting Type		
		1/4" MNPT	1/2"- 20UNF-2B	M12x1-8
5 VDC ±10%	Wet	224504	224501	224508
	Dry	224505	224502	224509
12 VDC ±10%	Wet	224506	224503	224510
	Dry	224507	223625	224511



ELS-950 shown with over-molded electronics and o-ring sealing exposed. Actual units are not designed for disassembly.

Wiring Diagrams

