

# Multiple Level Switch LS-800E-PVC (1...4 switch points)

Max. contact loads of the reed switch: SPST 100 VA; 3 A; 250 Vac (NC/NO).  
 SPDT 20 VA; 0.5 A; 250 Vac (Change-over contact).  
 The data NC/NO are defined for: an empty tank / rising level.

## Specifications

<b>Materials</b>	
Stem	PVC
Mounting elements	PVC
Float	PVC
<b>Electrical connection</b>	Terminal Box (ABS) 6 pole Pg 9 cable gland with 1m PVC-cable (0.34/0.25mm <sup>2</sup> )
<b>Operating pressure</b>	1.0 bar
<b>Temperature</b>	-20°C ... +60°C
<b>Min. specific gravity of the liquid</b>	0.75 g/cm <sup>3</sup>
<b>Depth of immersion at a density of 1</b>	~22mm
<b>Protection rating</b>	IP65



LEVEL SWITCHES

## Mounting Direction

Tank top : O	Bottom : U
--------------	------------

## Mounting Elements

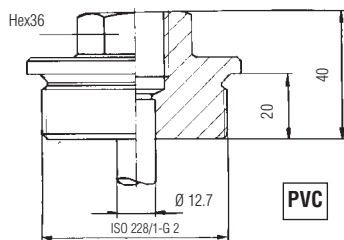

## Floats

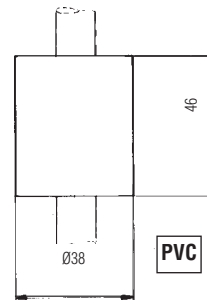

## Electrical Connection

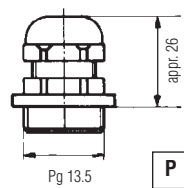
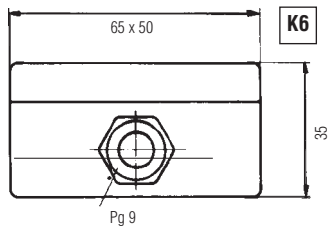

## Switching groups PVC model

Group 1, max 4 switch points, NC/NO

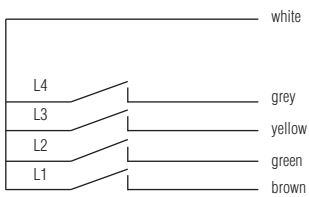

Group 3, max 2 switch points, (SPDT)

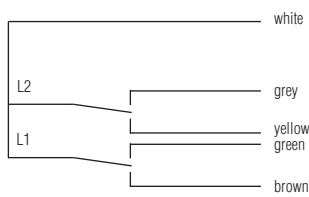

Group 2, max 3 switch points, NC/NO

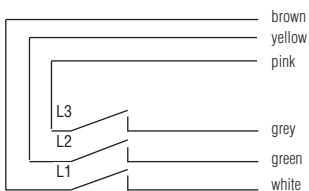

Group 4, max 2 switch points, (SPDT)

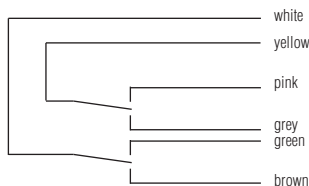

# LS-800E-PVC Multiple Level Switch check list

(Please copy and use as order form)

Customer: \_\_\_\_\_

Order no.: \_\_\_\_\_ Quantity: \_\_\_\_\_

**Application specific data:**  
(Please complete fully and accurately)

1. Medium \_\_\_\_\_
2. Pressure (bar): Min \_\_\_\_\_ Max \_\_\_\_\_
3. Temperature (°C): Min \_\_\_\_\_ Max \_\_\_\_\_
4. Specific gravity (g/cm3): \_\_\_\_\_ Min \_\_\_\_\_ Max \_\_\_\_\_
5. Viscosity (SSU): \_\_\_\_\_
6. Tank: Material \_\_\_\_\_ Depth \_\_\_\_\_
7. Connection periphery (eg relay, PLC,.....): \_\_\_\_\_

**LS-800E - PVC** ..... 1. 2. 3.

**Order data**

1. **Mounting direction:**
  - Through tank top  0
  - Through tank bottom  U
2. **Electrical connection:**
  - Pg9 cable and gland (standard length: 1m)  P
  - Terminal box 6-poles (ABS)  K6
3. **Switching:**
  - Group 1  1
  - Group 2  2
  - Group 3  3
  - Group 4  4

**Dimensions PVC Model**

- A = 58mm min. distance to upper switch point
- B = 50mm min. distance stem end to lowest switch point
- C = 75mm min. distance between two switch points
- D = 7mm min. distance between two switch points actuated by one float

Reference edge  
(Sealing Face)

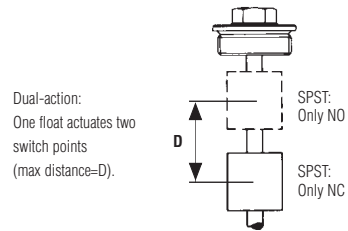
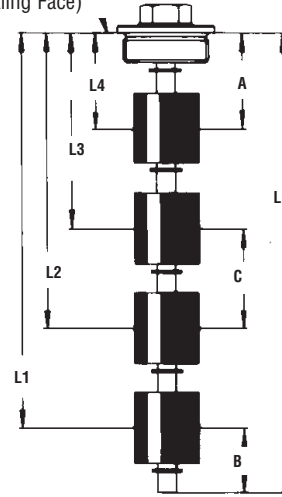

**MULTI POINT**

**LEVEL SWITCHES**

**Level Dimensions**

(Tolerance ±3mm) related to the mid of float

Distance level	NO group 1	NC group 1	NO group 2	NC group 2	SPDT group 3	SPDT group 4
L1 =	<input type="checkbox"/>	<input type="checkbox"/>	<input type="checkbox"/>	<input type="checkbox"/>	<input type="checkbox"/>	<input type="checkbox"/>
L2 =	<input type="checkbox"/>	<input type="checkbox"/>	<input type="checkbox"/>	<input type="checkbox"/>	<input type="checkbox"/>	<input type="checkbox"/>
L3 =	<input type="checkbox"/>	<input type="checkbox"/>	<input type="checkbox"/>	<input type="checkbox"/>		
L4 =	<input type="checkbox"/>	<input type="checkbox"/>				
L0 =	±2mm		max 2000mm			